

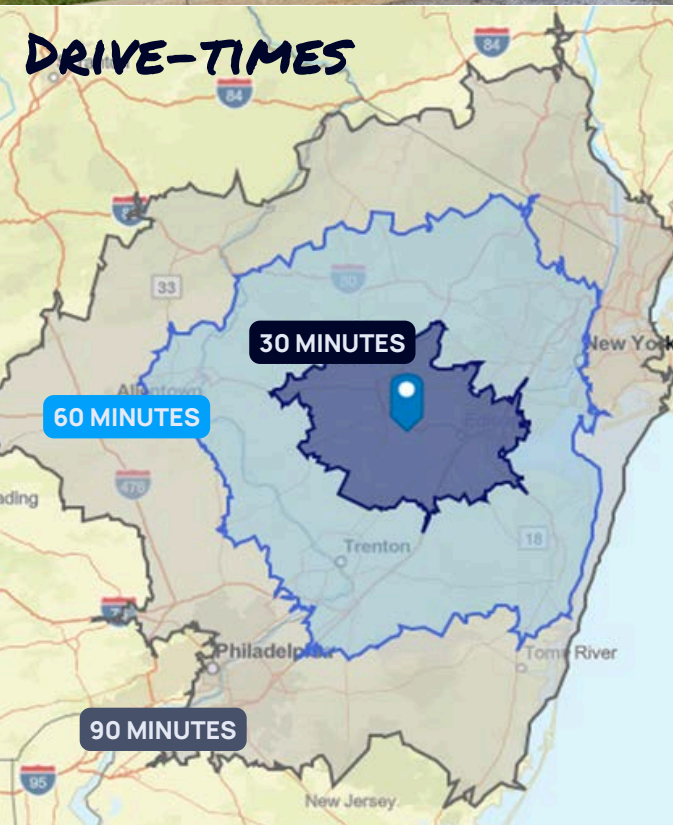

635 PIERCE STREET
SOMERSET, NJ

67,500 SF



- 3,491 SF OFFICE
- 64,009 SF WAREHOUSE
- BUILT IN 2002
- FIFTEEN (15) LOADING DOCKS
- ONE (1) DRIVE-IN DOOR
- 50' X 40' COLUMNS
- 32' CLEAR HEIGHT
- ESFR SPRINKLER SYSTEM
- 400 AMP, 480V. 3-PHASE ELECTRICAL SERVICE
- AMPLE PARKING

3D TOUR 

635 PIERCE STREET SOMERSET, NJ

SITE PLAN

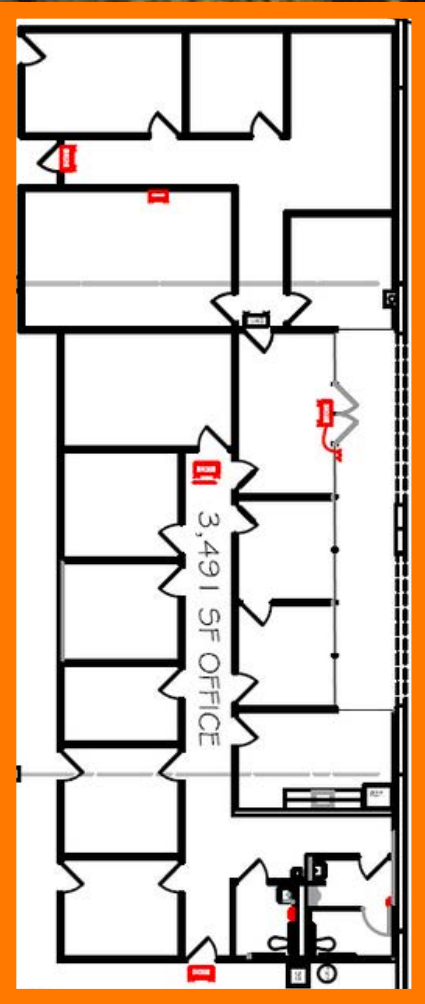

OFFICE BLOW-UP

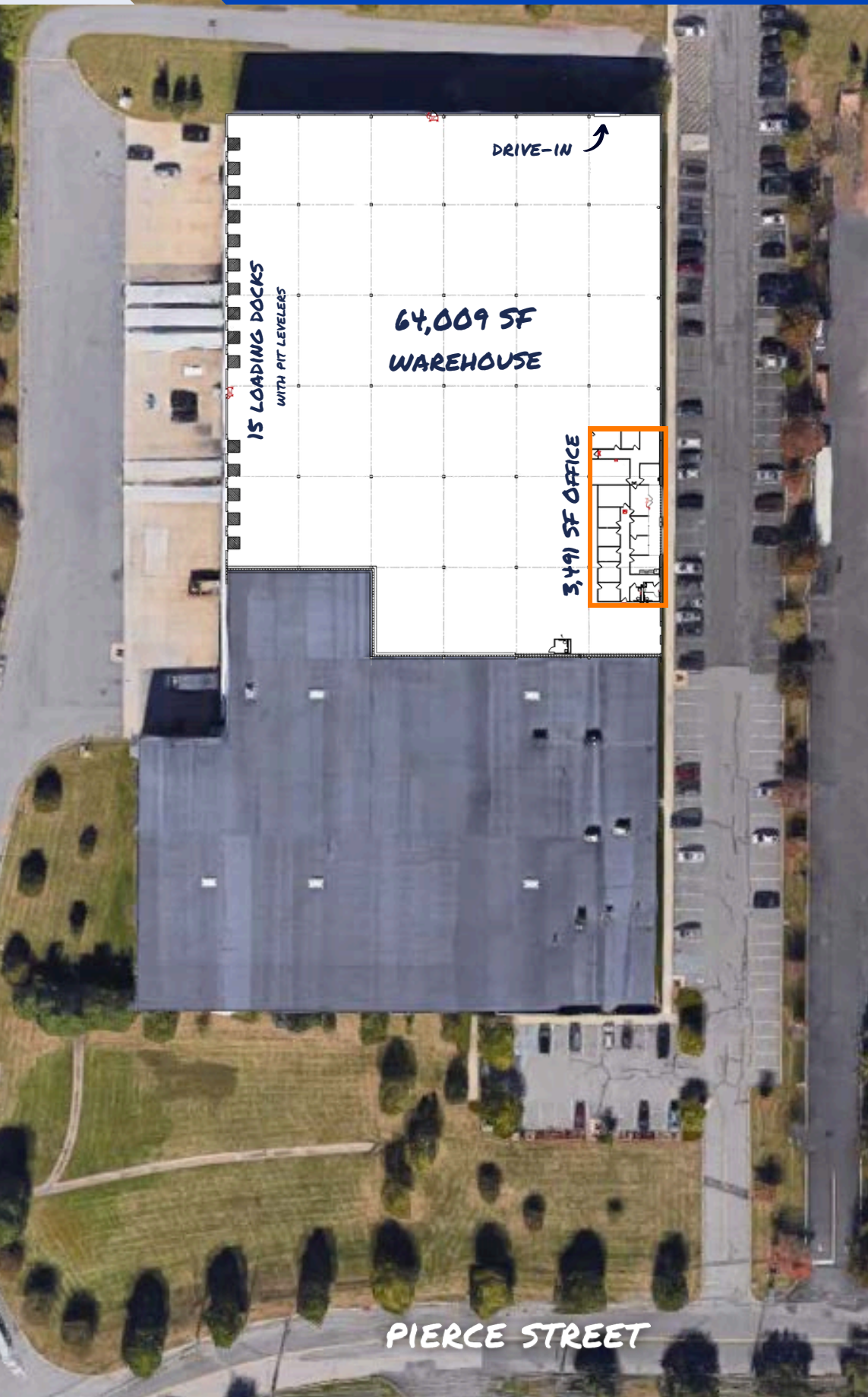

PIERCE STREET

AREA MAP

635 PIERCE STREET

SOMERSET, NJ



FOR MORE INFORMATION

JASON FISCH, BROKER | VICE PRESIDENT OF LEASING
☎ 732-258-3400 ✉ JASON.FISCH@GREEKREP.COM

PATRICK REISTROM | SENIOR LEASING ASSOCIATE
☎ 732-609-5829 ✉ PATRICK.REISTROM@GREEKREP.COM

GREEK
REAL ESTATE PARTNERS

1 KIMBERLY ROAD, SUITE 105
EAST BRUNSWICK, NJ 08816

